

youngAmerica®

540 Bunk Bed Assembly Instructions

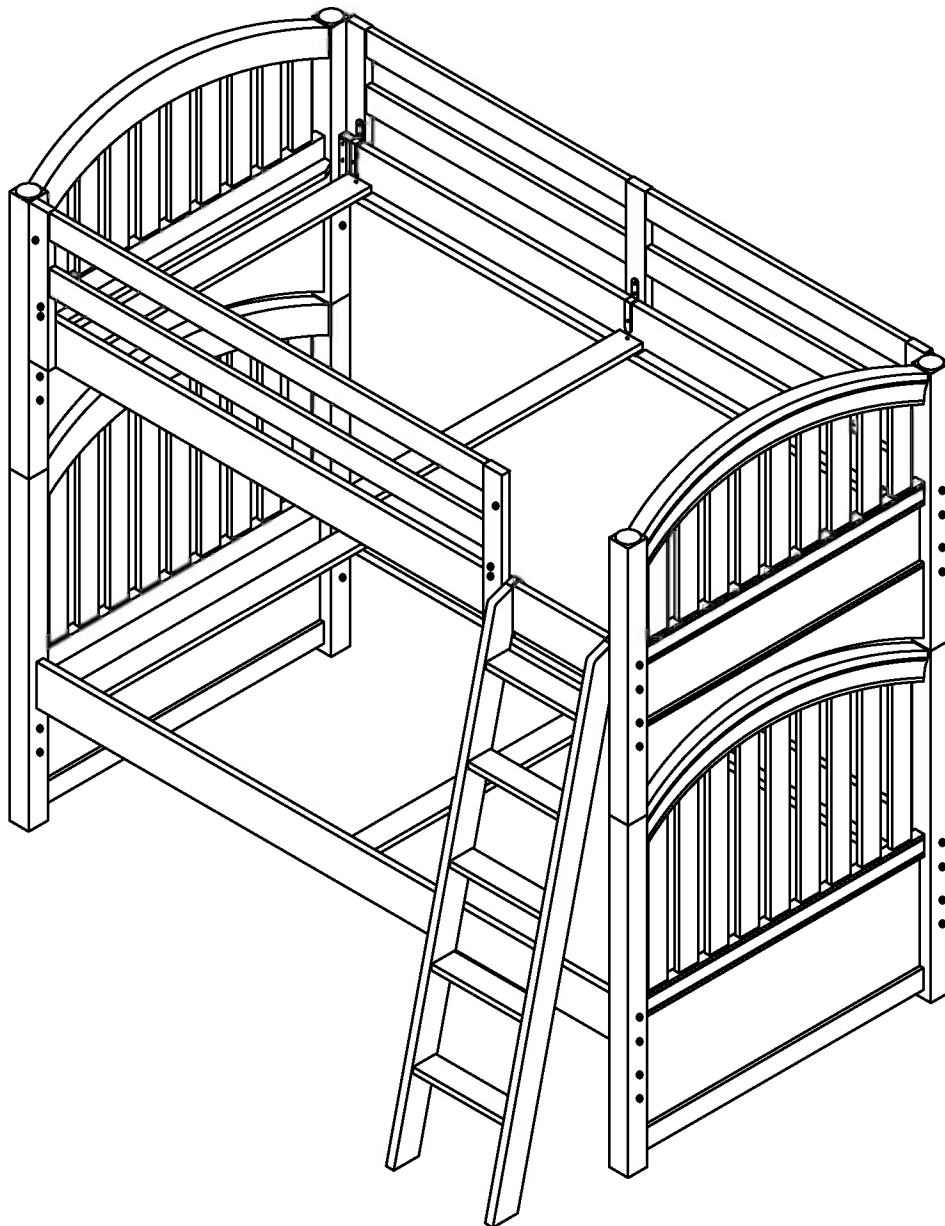

Young America bunk beds are designed with your child's safety in mind. They are certified to meet all safety guidelines set by the CPSC-Consumer Product Safety Commission and the ASTM-American Society for Testing and Materials.

Thank you for purchasing a Young America Bunk Bed. If you find that you are missing a part or if a part is defective in any way, contact your Young America retailer for assistance.

youngAmerica®

A registered trademark of Stanley Furniture Company, Inc.

READ THESE INSTRUCTIONS CAREFULLY BEFORE ATTEMPTING TO ASSEMBLE THIS BED. SAFETY WARNINGS:

1. Follow the information on the **WARNINGS** appearing on the upper bunk end structure and on the carton. **DO NOT REMOVE WARNING LABEL FROM BED.**
2. Always use the specified size mattress or mattress support, or both to help prevent the likelihood of entrapment or falls.
3. Surface of mattress must be at least 5 inches below the upper edge of guardrails.
4. Do not allow children under 6 years of age to use the upper bunk.
5. Prohibit more than one person on upper bunk.
6. Periodically check and ensure that the guardrails, ladder, and other components are in their proper position, free from damage, and that all connectors are tight.
7. Do not allow (horseplay) on or under the bed and prohibit jumping on the bed.
8. Always use the ladder for entering and leaving the upper bunk.
9. Do not use substitute parts. Contact your Stanley dealer for replacement parts.
10. Use of a night light may provide added safety precaution for a child using the upper bunk.
11. Use guardrails on both sides of the upper bunk.
12. If the bunk bed will be placed next to a wall, the guardrail that runs the full length of the bed should be placed against the wall to prevent entrapment between the bed and the wall.
13. The use of water or sleep flotation mattresses is prohibited.
14. **STRANGULATION HAZARD** - Never attach or hang items to any part of the bunk bed that are not designed for use with the bed: for example, but not limited to, hooks, belts, and jump ropes.
15. Keep these instructions for future reference.

WARNING

TO HELP PREVENT SERIOUS OR FATAL INJURIES FROM ENTRAPMENT OR FALLS:

- Never allow a child under 6 years on upper bunk.
 - Use only mattress which is 74"-75" long and 37 1/2"-38 1/2" wide on upper bunk.
 - Ensure thickness of mattress and foundation combined does not exceed 11" and mattress is at least 5" below upper edge of guardrails.
 - Use guardrails on both sides of upper bunk.
 - Prohibit horseplay on or under bed(s).
 - Prohibit more than one person on upper bunk.
 - Use ladder for entering and leaving upper bunk.
- STRANGULATION HAZARD** - Never attach or hang items to any part of the bunk bed that are not designed for use with the bed: for example, but not limited to, hooks, belts, and jump ropes.

DO NOT REMOVE THIS LABEL

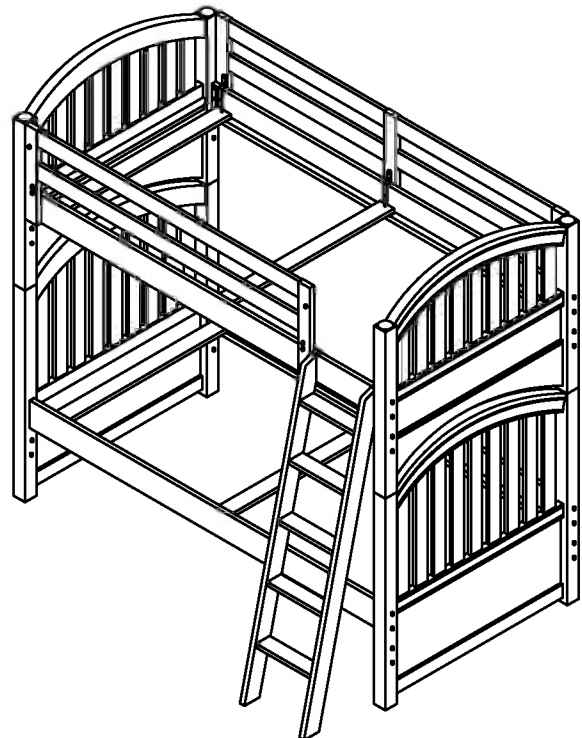

youngAmerica®

A registered trademark of Stanley Furniture Company, Inc.

Identifying the Parts (540 Bunk Bed)

The bunk bed illustrations in these instructions are generic in nature. The bunk bed you have purchased may not look like the ones illustrated; however, they all assemble in the same manner.

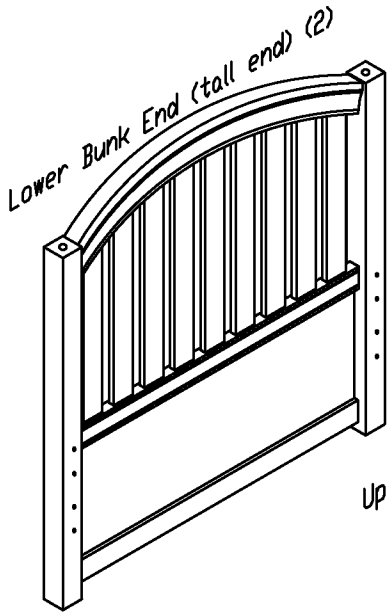

Mushroom Cap (4)



FOR BUNK BED CONFIGURATION

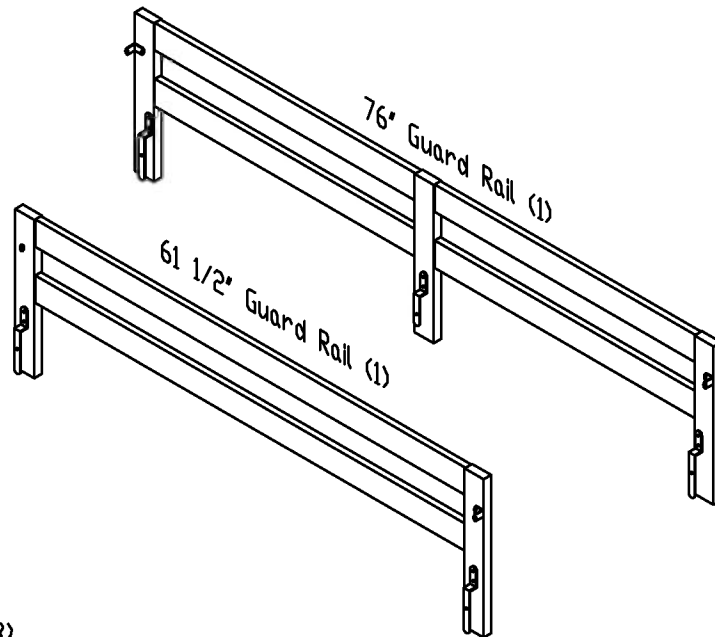
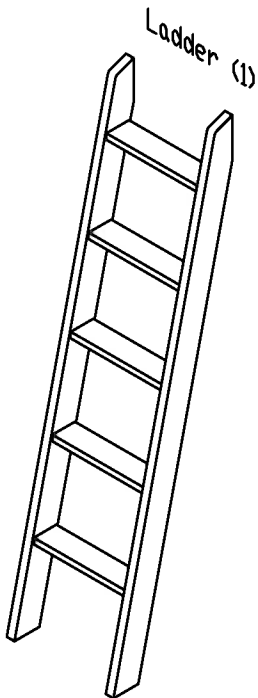
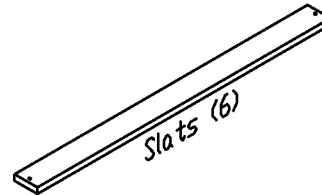
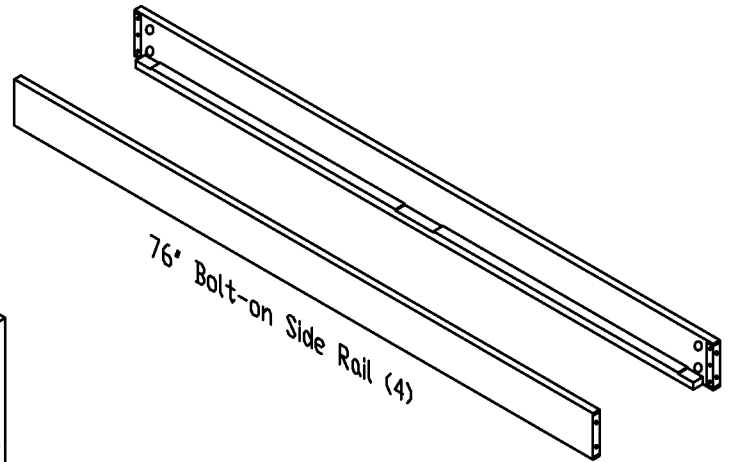
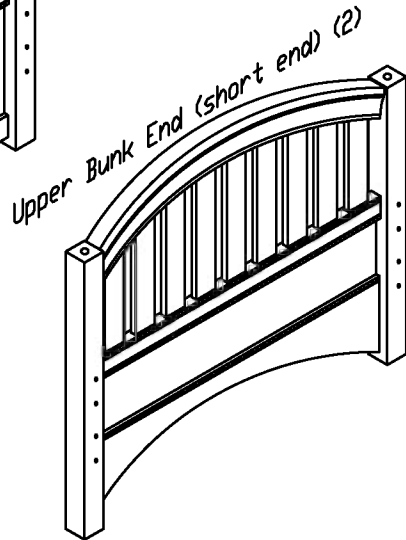

Finial (8)



FOR TWIN BED CONFIGURATION ONLY

Identifying the Hardware

Allen head bolt - (1/4"-20 thread) (16)

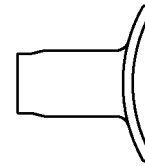
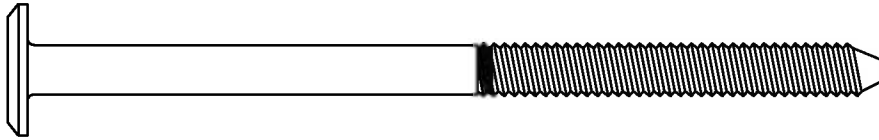

Flanged T-nut (16)

Threaded hole plug with cap (16)

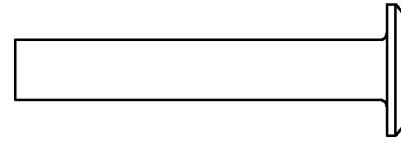
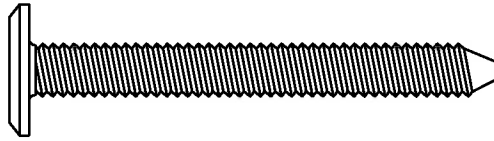

Guardrail bolt and cap (4)
(3/4 X 1/4-20 thread)

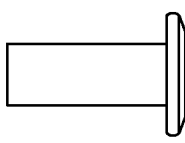
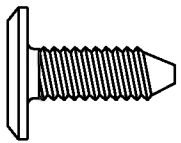

Guardrail bolt (4)
(1 X 10-24 thread)



Slat screw - #8 X 1 1/4" (12)

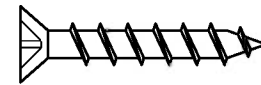

Allen wrench (2)

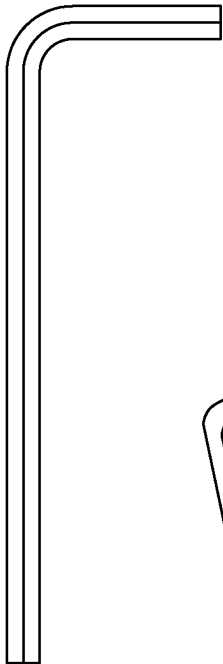

L brackets (3)

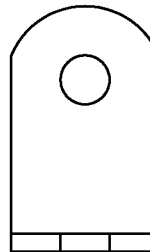
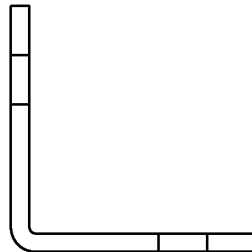

Guardrail bracket screws
#6 X 5/8" wood screw (5)



Ladder bracket (2) with #6 X 3/4" wood screw (4)

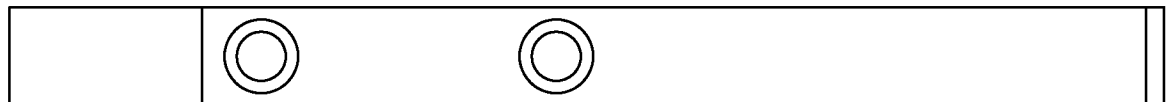
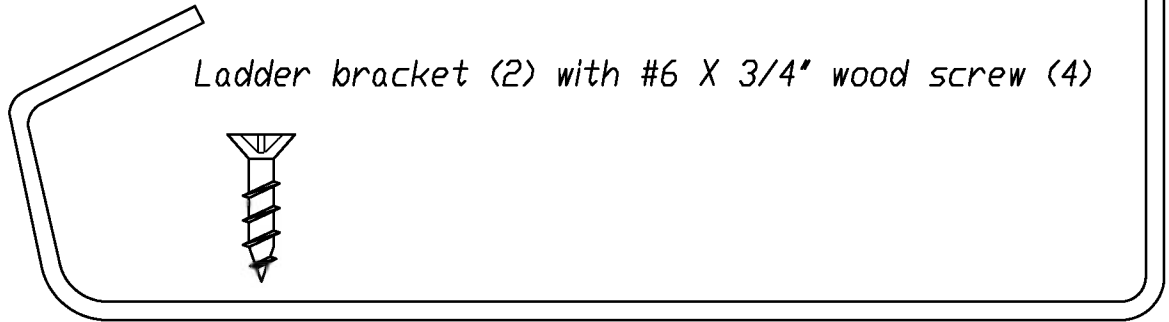

Dowel pin 3 1/4" long X 5/8" diameter (4)

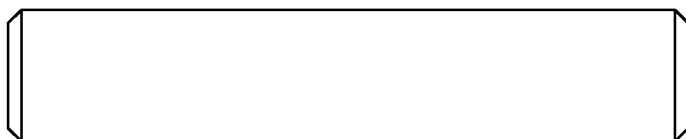

540 Bunk Bed Assembly Instructions - Step 1

****2 people are recommended for assembly of your bunk bed****
****Assembly requires the use of a phillip or square drive screwdriver****

STEP 1: Lower Bunk Assembly Instructions:

****If you are planning to set your bed up as 2 twin beds, use 1 lower bunk end (tall end) and 1 upper bunk end (short end) per bed. Attach the side rails as described and shown below.**

1. If you have purchased the #570 extension kit, attach 1 rail to the posts of the lower bunk bed ends that will be the back side of the bed at this time.
2. Attach the side rails to the lower bunk bed ends (tall ends) using t-nuts, the longest allen head bolts, and the allen wrench that is provided (Refer to Section "A"). Use the upper set of holes (high position) in the posts if you plan to use any under bed options with your bunkbed. If not, either set of holes can be used. Place t-nuts in the holes on the back of the side rails. Align the side rails with the holes in the posts and fasten tightly with allen head bolts using the allen wrench provided.
3. Install threaded hole plugs and caps into the unused holes in each post using the shorter allen head bolts, caps, and two allen wrenches that are provided.

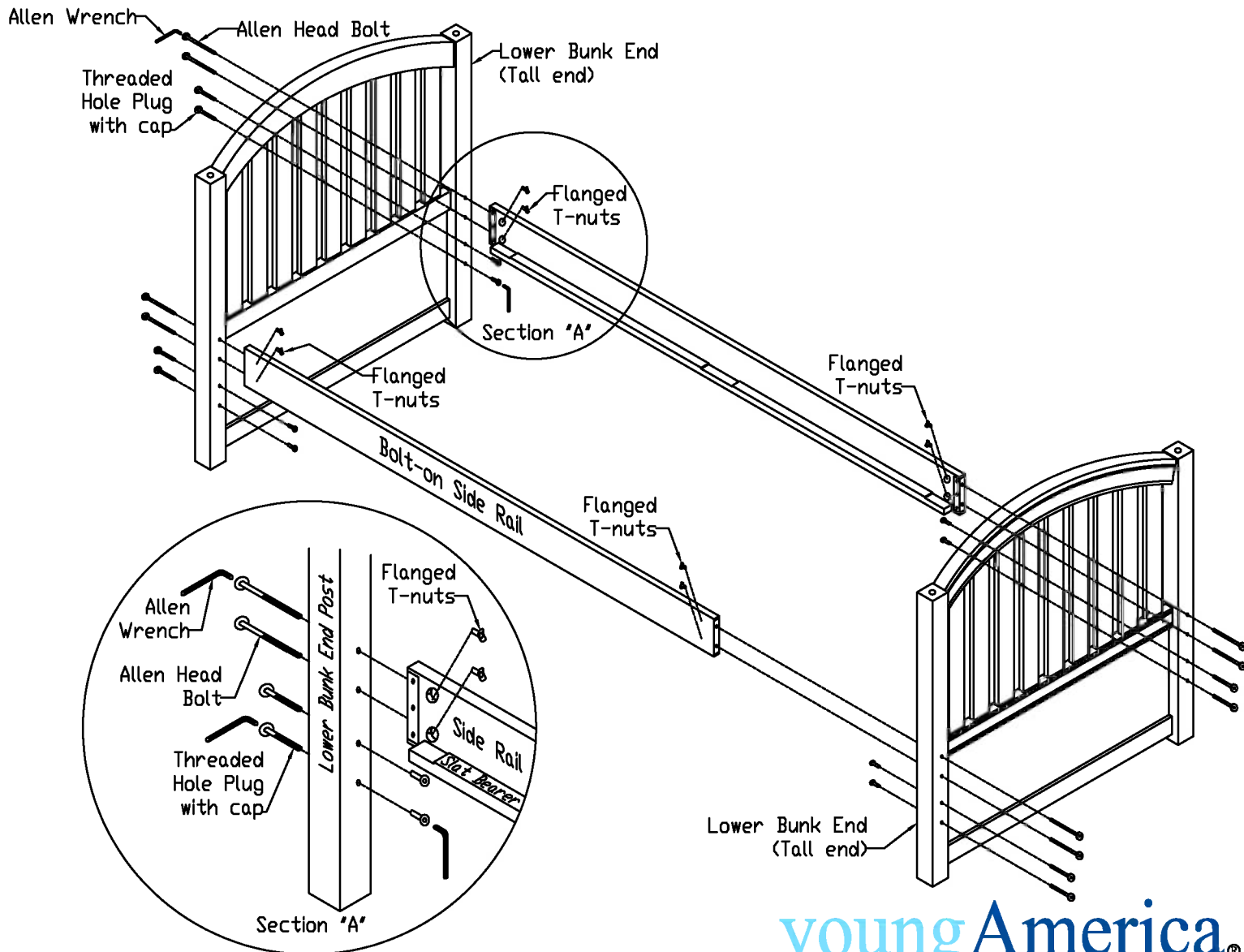

STEP 2: Upper Bunk Assembly Instructions:

Note: If you have set your beds up as 2 twin beds, install finials in the top of the posts and proceed to page 8, slat installation instructions. For bunkbed assembly, proceed with these assembly steps.

1. Install 3 1/4" long X 5/8" diameter wooden dowels into the top of the posts of the lower bunk.
2. Carefully place the upper bunk ends (short ends) on top of the lower bunk assembly. Make sure to turn the fill rails to the inside as shown below.

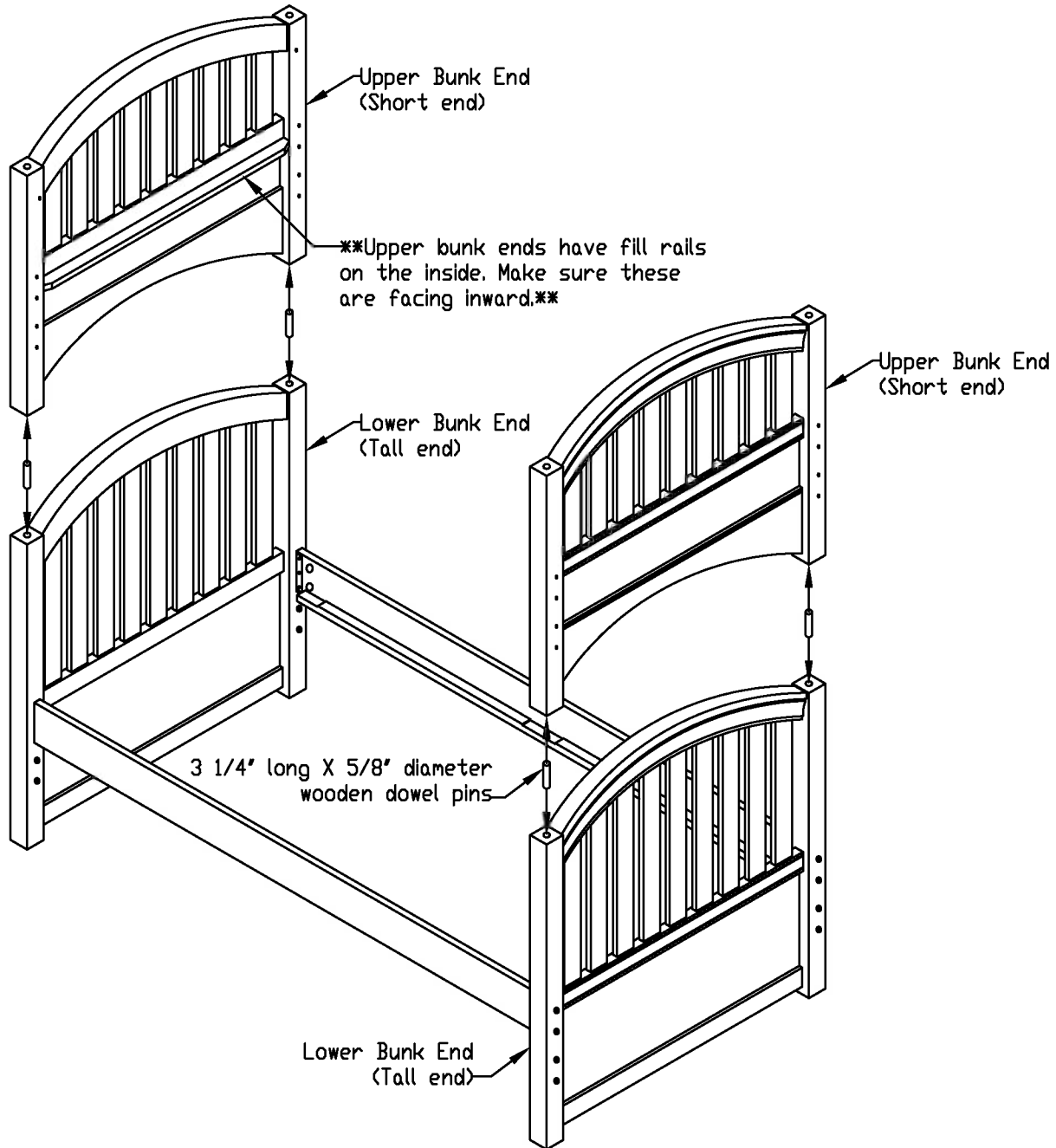

540 Bunk Bed Assembly Instructions - Step 3

STEP 3: Upper Bunk Assembly Instructions:

1. Attach the side rails to the upper bunk bed ends (short ends) using t-nuts, the longest allen head bolts, and the allen wrench that is provided (Refer to Section "A"). For proper alignment of the fill rails and correct fit of the ladder use the upper set of holes (high position) in the posts, only. Insert t-nuts into the holes on the back of the side rails. Align rails with the upper set of holes and fasten securely with bolts and allen wrench.
2. Install threaded hole plugs and caps into the unused holes in each post using the shorter allen head bolts, caps, and two allen wrenches that are provided.

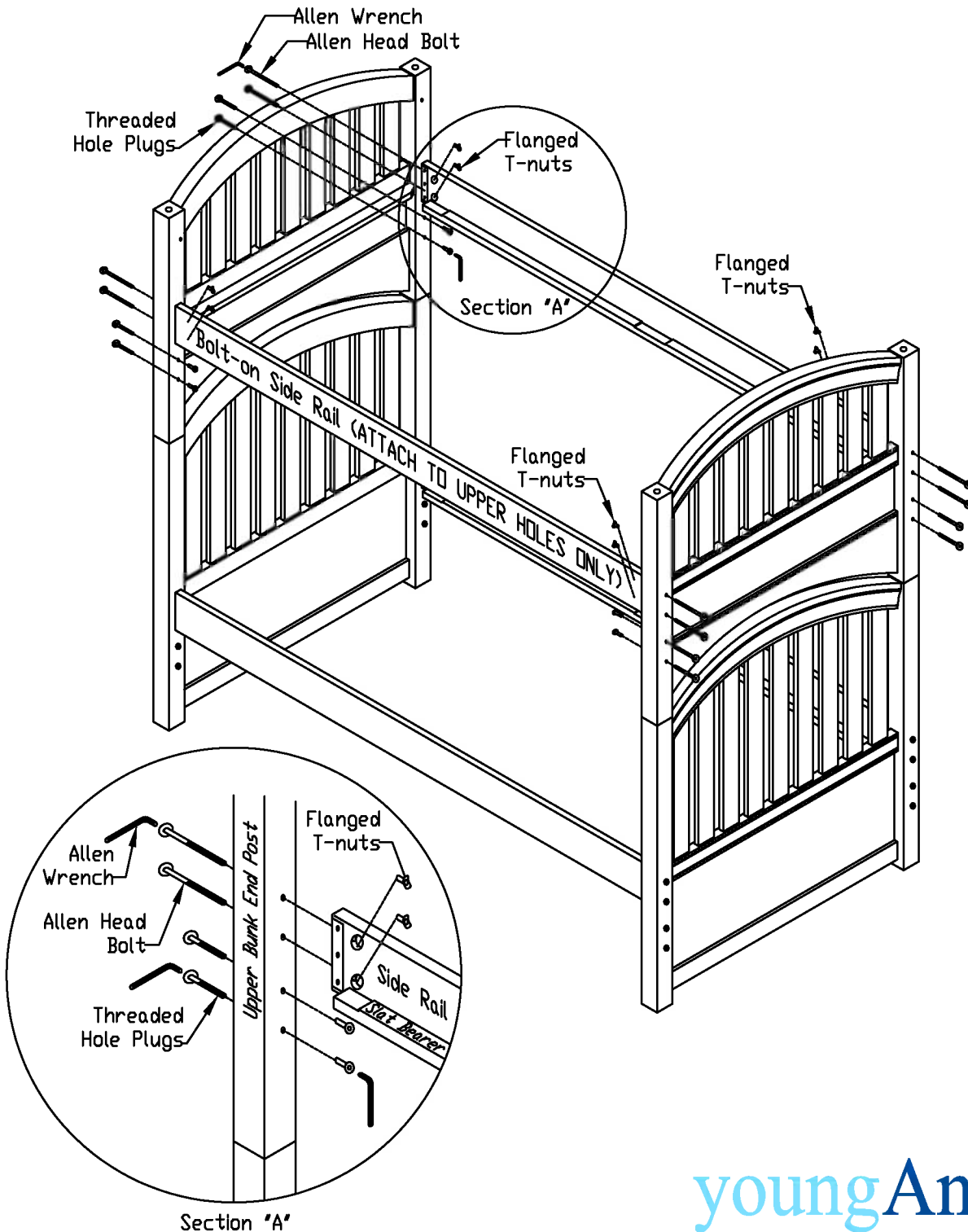

540 Bunk Bed Assembly Instructions - Step 4

STEP 4: Slat Installation Instructions:

**If you have purchased the #570 extension kit, please refer to the instructions provided with it before beginning installation of the slats.

1. Place a slat in each of the 3 notches in the slat bearer on the side rails of the upper bunk (Refer to Section "A"). Secure the ends of each slat with (1) 1 1/4" X #8 screw in the pre-bored hole in each end of the slats.
2. Repeat Step 1 to attach the slats to the slat bearers on the side rails of the lower bunk. Note: If you purchased the #375 storage box(es), install the #275 guide rail on the bottom bunk at this time. Refer to the instructions for the #275 at this time.

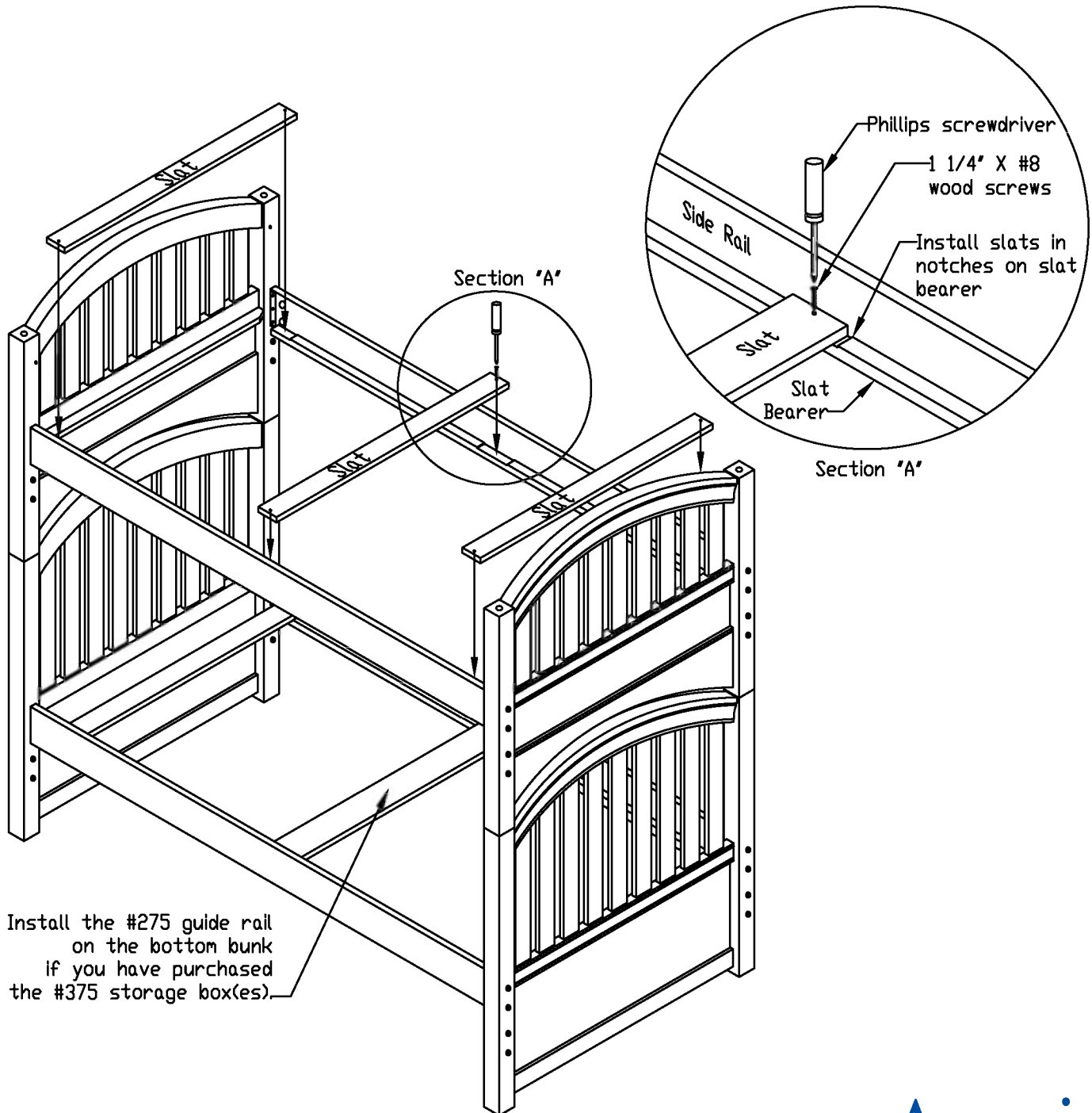

540 Bunk Bed Assembly Instructions - Step 5

STEP 5: Guardrail and Mushroom Cap Installation Instructions:

1. Install 2 guardrails as indicated below and in Section "A". The 61 1/2" guardrail can be placed at either end of the bed that you desire. The metal brackets on the guardrails fit into slots in the slat bearers on the side rails (Refer to Section "A"). Secure all brackets with #6 X 5/8" screws that are provided.

2. Attach the L brackets on the ends of the guardrails to the posts of the upper bunk by using the 1" X 10-24 bolts that are supplied with the guardrails and the allen wrench that is provided (Refer to Section "A"). Note: The L bracket on the 61 1/2" guardrail can be attached to either end depending on which end of the bed you want your ladder to be. Install a 1" X 10-24 guardrail bolt into the unused hole in the post that is located where the ladder will be attached (Refer to Section "B").

3. For your child's safety and to help prevent serious injury, use mushroom caps only on upper posts when unit is set up in a Bunk Bed configuration as shown in the instructions.

Note: The decorative finials provided are only to be used when bed is set up as Twin Beds. Never use decorative finials on a Bunk Bed.

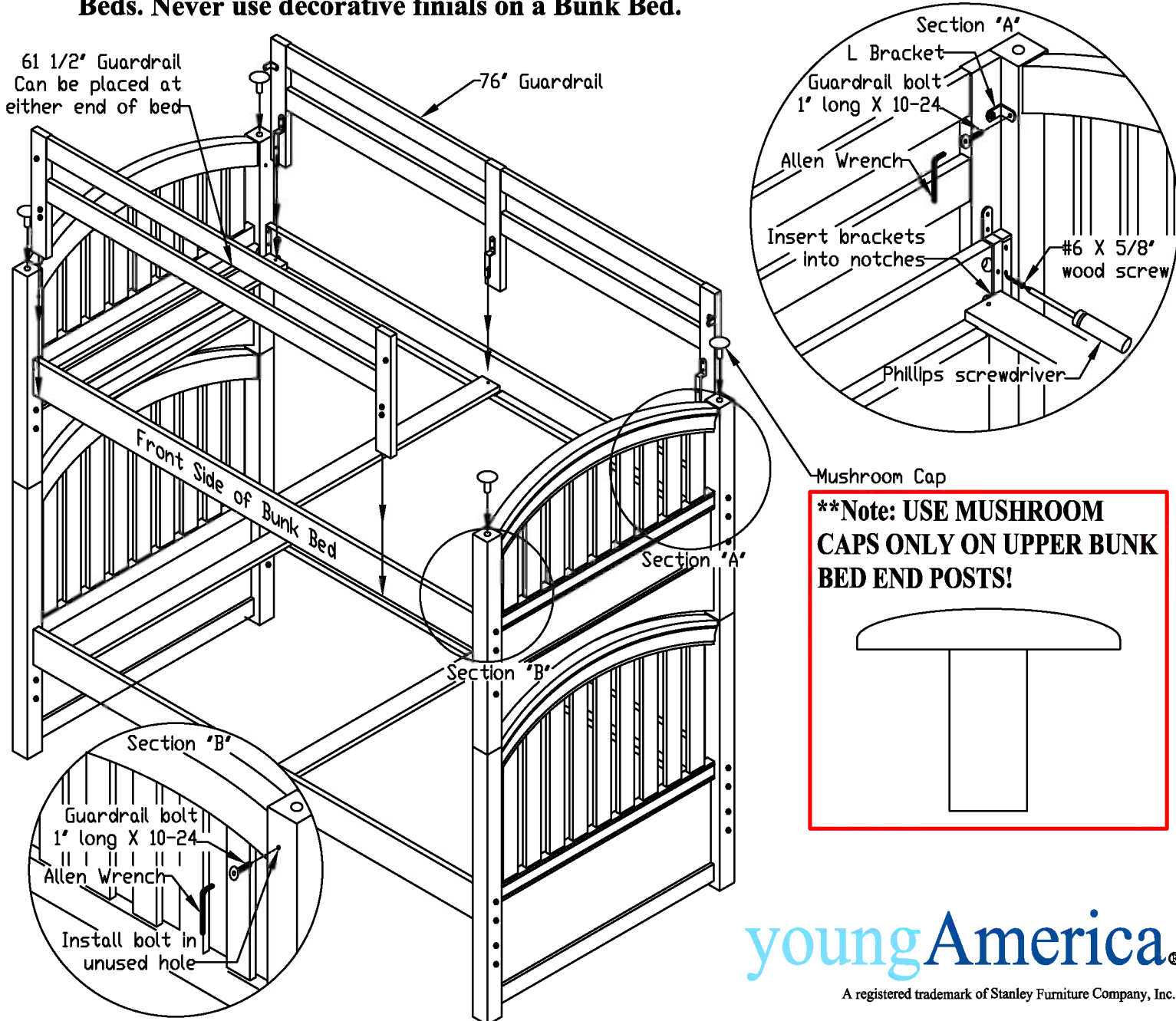

STEP 6: Attach Ladder Brackets:

1. Lay ladder flat with the pre-drilled pilot holes facing upward on a carpeted floor or soft pad to avoid scratching the finish while attaching the ladder brackets to the ladder.

2. Align one of the ladder brackets with the pre-drilled pilot holes on the inside of the top of the ladder side (Refer to Section "A"). ***NOTE: STRAIGHT LEG MUST BE ON BOTTOM***

Attach the bracket with 2 of the #6 X 3/4" long flat head phillips wood screws that are provided.

***NOTE: MAKE SURE TO TIGHTEN SCREWS SO THAT THE HEAD OF THE SCREWS SEAT INTO THE HOLES IN THE BRACKET. THIS WILL ASSURE THAT THE SCREWS WILL NOT SCRATCH THE FINISH ON YOUR SIDE RAIL.**

3. Repeat Step 2 to attach the ladder bracket to the other ladder side.

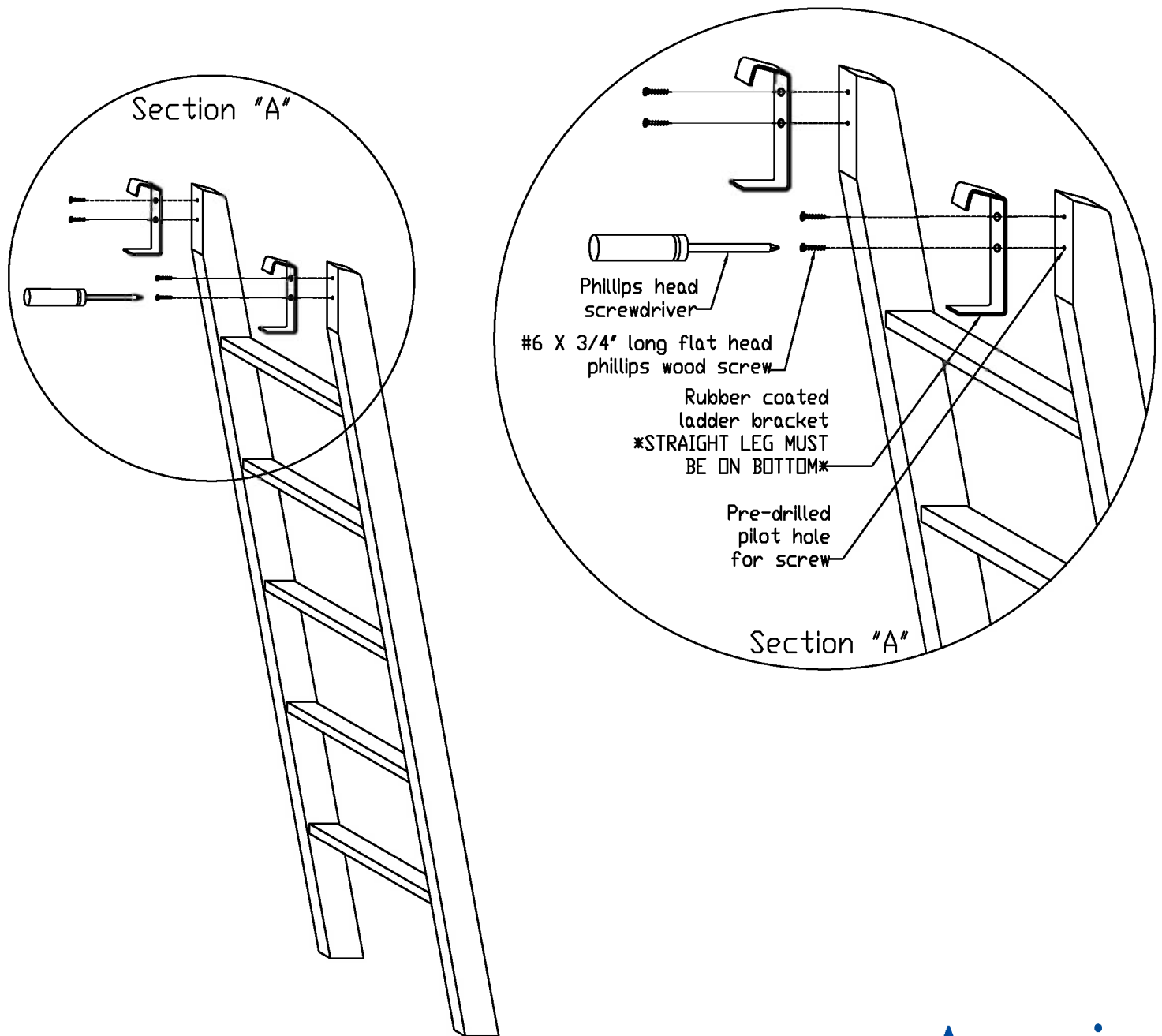

540 Bunk Bed Assembly Instructions - Step 7

STEP 7: Ladder Attachment Instructions:

1. Position the ladder in the opening between the 61 1/2" guardrail and the post of the upper bunk. Rotate the bottom of the ladder outward (Refer to Section "A"). Hook the top portion of the ladder brackets over the side rail and then lower the bottom of the ladder until it touches the floor.
3. To detach the ladder, lift the bottom of the ladder, then raise the ladder up and outward away from the side rail.

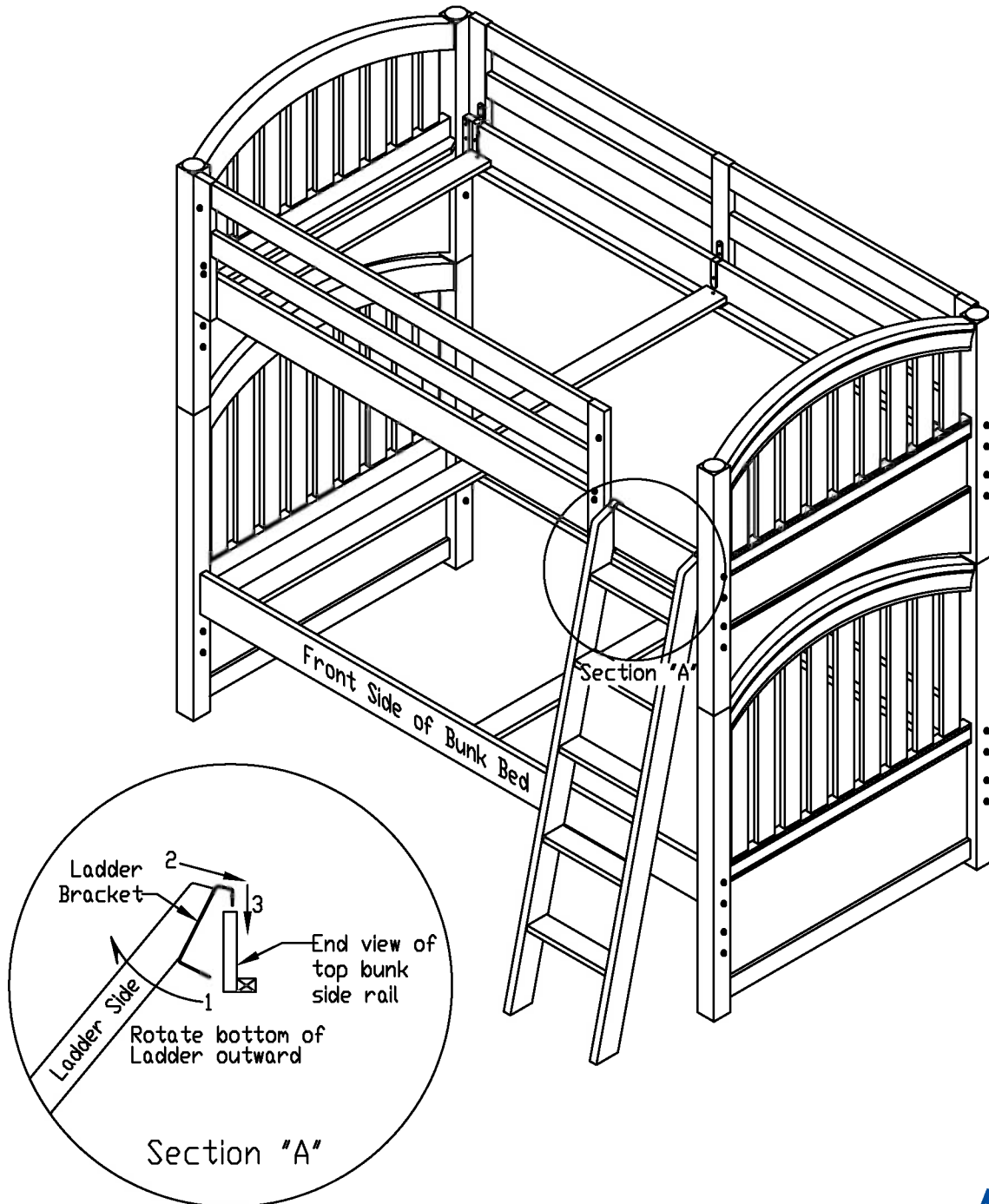

STEP 8: Install Bedding:

BEDDING SPECIFICATION:

The following size Mattress and Foundation are specified for use with this Bunkbed:

MATTRESS: 37 1/2" to 38 1/2" X 74" to 75" X 9" MAXIMUM THICKNESS

BUNKIE BOARD: 38" X 74 1/2" X 2"

****NOTE:** MATTRESS AND BUNKIE BOARD/BOX SPRING MUST NOT EXCEED 11" TOTAL THICKNESS

Be sure to adhere to these BEDDING SPECIFICATIONS. In order to avoid the possibility of falling or entrapment, THESE SPECIFICATIONS MUST BE STRICTLY ADHERED TO!

UPPER BUNK MATTRESS DIAGRAM

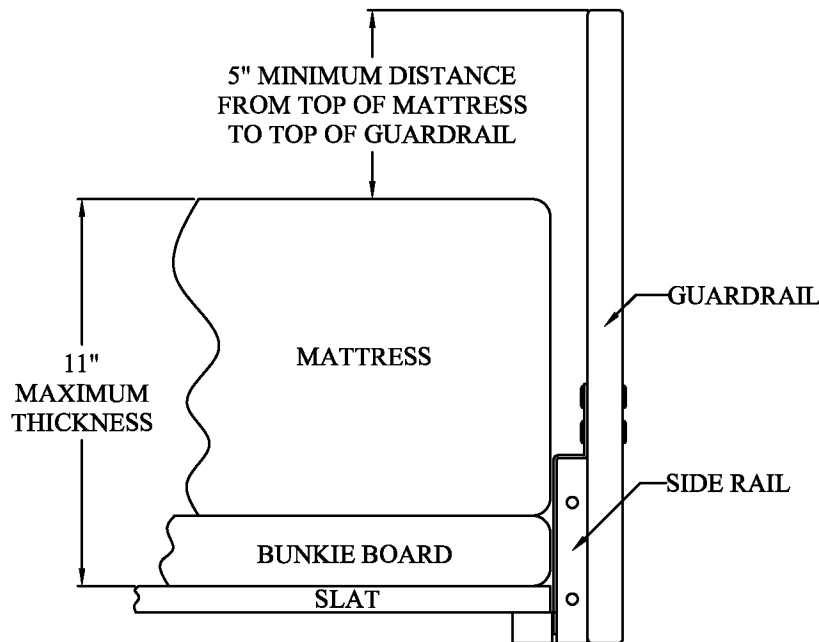

KEEP THESE INSTRUCTIONS FOR FUTURE REFERENCE.

IMPORTANT: REPLACEMENT PARTS, INCLUDING ADDITIONAL GUARDRAILS, MAY BE OBTAINED FROM ANY OF OUR STANLEY DEALERS!

For additional consumer information, call our Customer Services Department at 1-(276) 627-2100 Monday-Friday, 8-5 Eastern.

Stanley Furniture
P.O. Box 30
Stanleytown, VA 24168

youngAmerica®

A registered trademark of Stanley Furniture Company, Inc.